

INSET

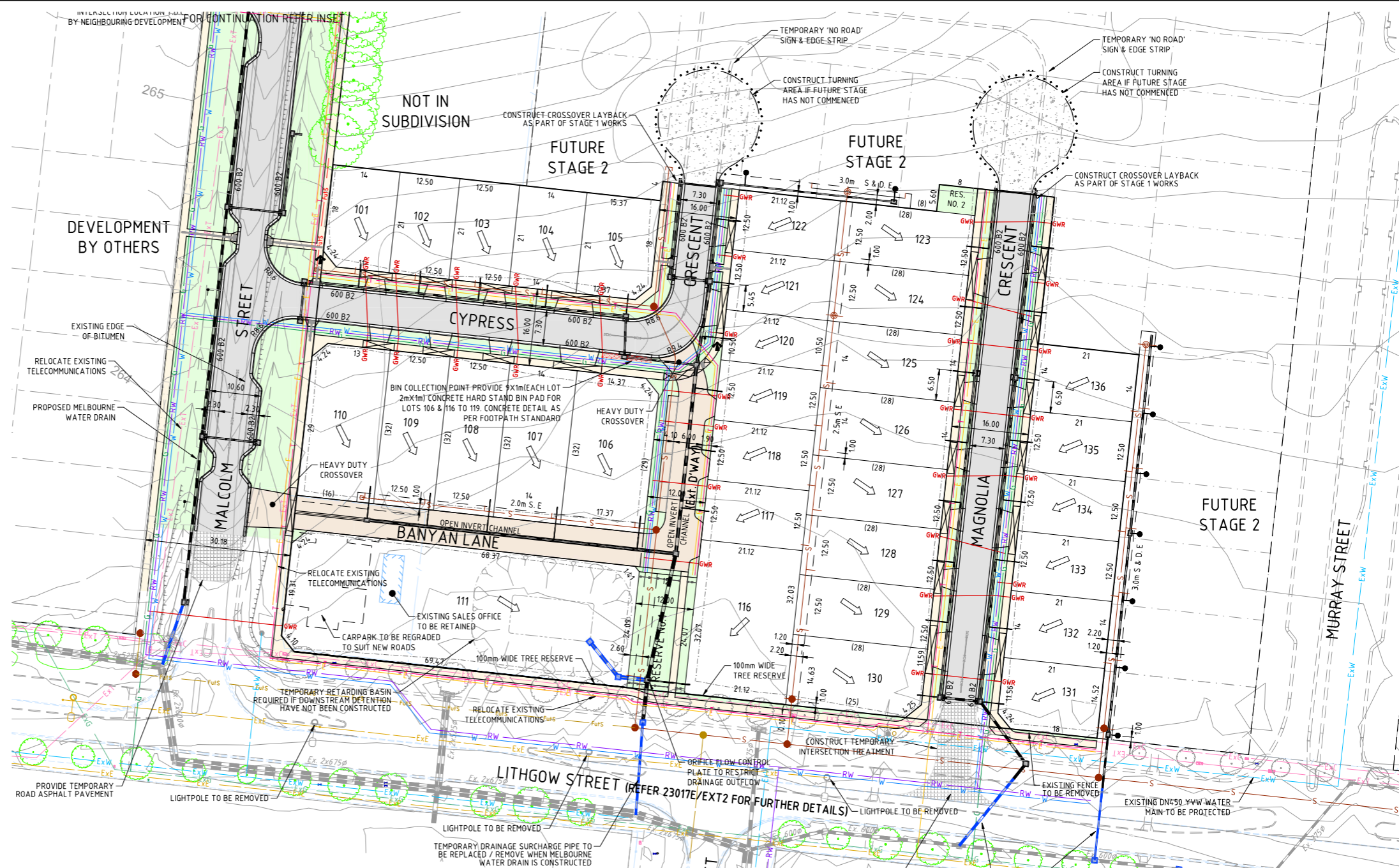

- LEGEND**
- OVERALL DIRECTION TO LEGAL POINT OF DISCHARGE
  - BIN SPACE
  - GAS & WATER CONDUIT
  - TEMPORARY DRAINAGE
  - TREE TO BE RETAINED
  - TREE TO BE REMOVED
  - BOLLARDS OR APPROVED EQUIVALENT TRAFFIC BARRIER AS INDICATED.
  - 600mm WIDTH B2 TYPE BARRIER KERB & CHANNEL AS PER EDMC 301
  - EXISTING SURFACE CONTOURS (0.25m INT.)
  - TEMPORARY TURNING AREA TO BE 10.5m RADIUS. BOLLARDS TO BE PLACED AT EVERY 1.5m
  - ROAD PAVEMENT
  - CONCRETE (TYPICAL)
  - CONCRETE (OTHER)
  - TEMPORARY INTERSECTION TREATMENT
  - RESERVE & NATURESTRIP

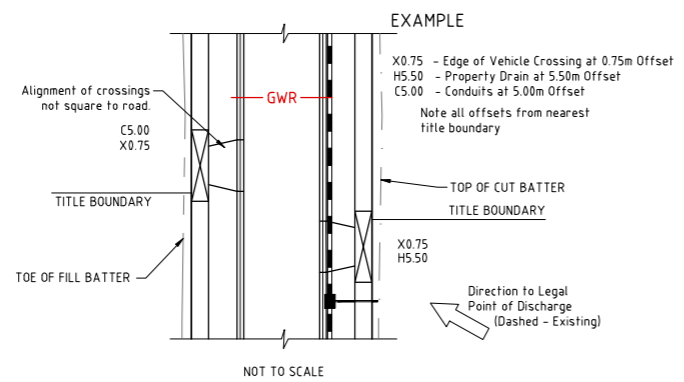

**WARNING**

**BEWARE OF UNDERGROUND SERVICES**

THE LOCATIONS OF UNDERGROUND SERVICES ARE APPROXIMATE ONLY AND THEIR EXACT POSITION SHOULD BE PROVEN ON SITE PRIOR TO COMMENCEMENT OF WORK. NO GUARANTEE IS GIVEN THAT ALL EXISTING SERVICES ARE SHOWN.

**SERVICES SCHEDULE**

STREET NAME	GAS	ND-WATER	D-WATER	TELCOMM.	ELECT.	SEWER	ROAD RESERVE
CYPRESS CRESCENT (LOT 101 TO 105)	2.10 S	2.60 S	3.10 S	1.85 N	2.50 N	1.00 N	16.00
CYPRESS CRESCENT (LOT 120 TO 122)	2.10 E	2.60 E	3.10 E	1.85 W	2.50 W	1.00 W	16.00
CYPRESS CRESCENT (Ext. DRIVE WAY LOT 117 TO 119)	0.70 W	1.15 W	1.60 W	0.50 E	1.00 E	3.00 W	12.00
MAGNOLIA CRESCENT	2.10 E	2.60 E	3.10 E	1.85 W	2.50 W	-	16.00
MALCOLM STREET	2.10 W	2.80 W	3.55 W	1.85 E	2.50 E	-	30.18
BANYAN LANE	-	-	-	-	-	-	7.00

\* DENOTES EXISTING SERVICE EXACT LOCATION TO BE PROVEN ON SITE BY CONTRACTOR. ALL OFFSETS ARE REFERENCED TO NEAREST BL.

**DISCLAIMER**

THE CONTENT ON THIS PLAN IS FOR PRELIMINARY PURPOSES ONLY AND IS SUBJECT TO DETAILED ENGINEERING DESIGN, APPROVAL BY CITY COUNCIL AND ALL SERVICE AUTHORITIES. AS SUCH THIS PLAN IS SUBJECT TO CHANGE WITHOUT NOTICE. THIS PLAN IS NOT TO BE USED FOR ANY PURPOSE OTHER THAN FOR PRELIMINARY PURPOSES. HOUSE SITING SHOULD ONLY BE COMPLETED ONCE COUNCIL APPROVED PLANS ARE ISSUED. THE DEVELOPER BEARS NO RESPONSIBILITY FOR ANY OF THESE CHANGES. THE PURCHASER SHOULD ASCERTAIN THE DETAILS ARE CORRECT BEFORE PROCEEDING.

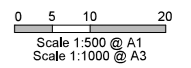

**PRELIMINARY PLAN ONLY**

NOT APPROVED FOR CONSTRUCTION

THIS DRAWING IS NOT TO BE COPIED OR SCALED

VERSION	REMARKS	DATE	BY
F	COUNCIL COMMENTS, GENERAL AMENDMENTS	30.04.20	LG
E	COUNCIL COMMENTS, GENERAL AMENDMENTS	24.01.20	LG
D	COUNCIL COMMENTS, GENERAL AMENDMENTS	18.12.19	LG
C	GENERAL AMENDMENTS	06.11.19	LG
B	GENERAL AMENDMENTS	15.03.19	LG

- LEGEND**
- DRAIN, PROPERTY INLET & PIT
  - EX DRAIN & PIT
  - HOUSE DRAIN
  - SEWER AND MAINTENANCE HOLE
  - EX SEWER AND MAINTENANCE HOLE
  - WATER MAIN
  - EX WATER MAIN, VALVE & HYDRANT
  - GAS MAIN
  - EX GAS MAIN, VALVE
  - TELSTRA SERVICES & PITS
  - EX TELSTRA SERVICES & PITS
  - LIGHT POLE
  - EX LIGHT POLE
  - ELECTRICAL SERVICE & PIT
  - EX ELECTRICAL ASSETS
  - EX ELECTRICAL OVERHEADS
  - GAS & WATER CONDUITS
  - EX G
  - TOP OF BATTERY
  - TOE OF BATTERY
  - FINISHED SURFACE AFTER CUTTING OR FILLING
  - TOP OF PROPOSED BATTER
  - PROPOSED PAVEMENT OR FOOTPATH SURFACE
  - EXISTING OR PROPOSED INVERT LEVEL OF PIPE OR OPEN DRAIN
  - TAMENANT POINT
  - PSM
  - EX FENCE
  - EX WALL OR BUILDING
  - STREET SIGN
  - DRAINAGE PIT No.
  - TBM

DRAWN BY	DESIGNED BY	CHECKED BY	AUTHORISED BY
N. KASHA	L. GRIFFIN	P. MILLER	S. RAVIDA



LAND SURVEYING  
CIVIL ENGINEERING  
PLANNING  
DEVELOPMENT CONSULTING

www.reedsconsulting.com.au  
engineering@reedsconsulting.com.au

Lvl 6, 440 Elizabeth Street Melbourne Victoria 3000  
p (03) 8640 3000

MITCHELL SHIRE COUNCIL		DRAWING No.	VERSION
TIMBARRA ESTATE		1G2	F
STAGE 1		REFERENCE	
FUNCTIONAL LAYOUT PLAN		23017E/1	
SHEET 1		SHEET	2 OF 5